

GTP

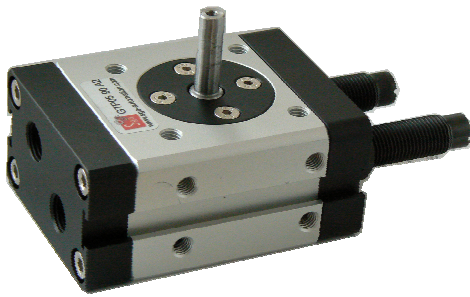

Estructura interna

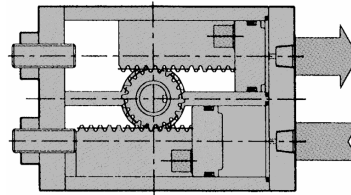

Especificacion

Modelos		GTP 05		GTP 10		GTP 20		GTP 30	
Datos tecnicos									
Operacion		Doble efecto							
Rango de presion	bar	1,5 ~ 7							
Pareja a 6 bars	Nm	0,38	0,88	1,86	2,94				
Calibre mm		∅ 16	∅ 20	∅ 25	∅ 30				
Angulo de rotacion	grado	90 - 180							
Angulo ajustable	grado	+ 5 ~ - 30							
Temperatura de operacion	°C	0 ~ 50							
Peso	g	90°	180°	90°	180°	90°	180°	90°	180°
		320	377	426	519	665	803	1068	1462

Angulo de rotacion

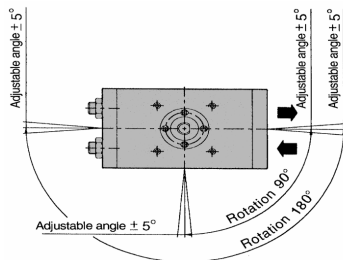

Pareja

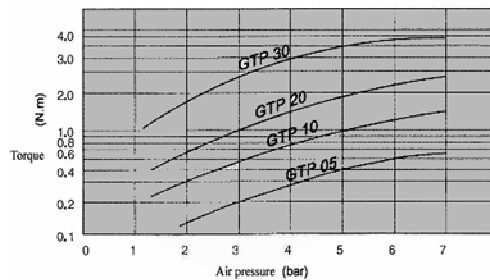

Forma de pedido

GTP	10	180	2 D	A 2
Unidad rotativa	Pareja real	Angulo de rotacion	Eje	Apagadores
	05 : 0,38 N.m 10 : 0,88 N.m 20 : 1,86 N.m 30 : 2,94 N.m	90 - 90° 180 - 180°	0 : Sola barra 2D : Doble barra	
				0 : No apagador A1 : 1 apagador A2 : 2 apagadores

Sensores

Contactenos



Montaje tipo

Archivos 2D y 3D descargable sobre www.sga-automation.com

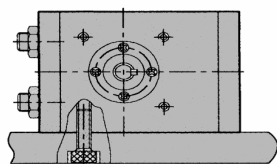

Side mounting

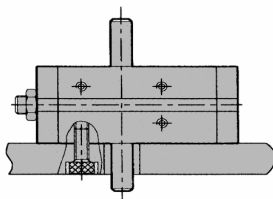

Bottom mounting

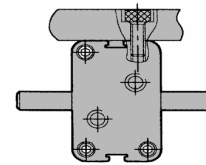

Top mounting



Congestiones

GTP 05

GTP 10 ~ 30

Sensor

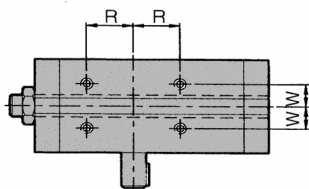

1 axe (standard)

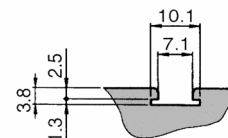
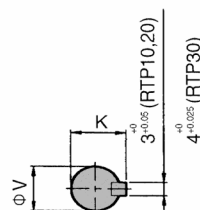
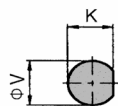

● One axis type (**Standard**)

● Both axis type (**2D**)

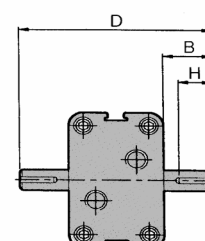
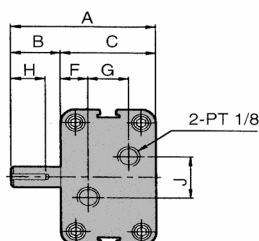
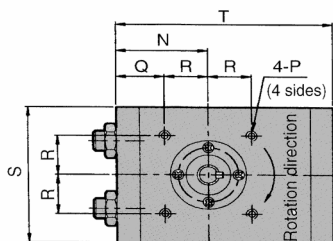

Modelo	A	B	C	D	F	G	H	J	K	N	P	Q	R	S	T	V	W
GTP 05 90°	52	20	32	72	11	10	10	16	5,5	30,5	M5×0,8dp 7	14,5	16 ±0,1	52	70	6 ^{h7}	8
GTP 05 180°										35,5		19,5					
GTP 10 90°	61	25	36	86	11	14	19	14	9,2	34,5	M5×0,8dp 7	17,5	17 ±0,1	56	81	8 ^{h7}	9
GTP 10 180°										44		27					
GTP 20 90°	72	30	42	102	12	18	19	20	11,2	40	M5×0,8dp 7	21	19 ±0,1	66	94	10 ^{h7}	10
GTP 20 180°										52		33					
GTP 30 90°	90	40	50	130	12	26	19	36	13,2	50	M6×1,0dp 8	22	28 ±0,1	78	110	12 ^{h7}	15
GTP 30 180°										71		43					

* Las dimensiones son solo de referencia, se podría sostener variaciones debido a los avances técnicos. Nos reservamos el derecho a modificar sin previo aviso.